

Porthouse Theatre  
Kent State Univ.  
1325 Theatre Dr.  
PO Box 5190  
Kent, OH 44242

Director: Terri Kent  
Set Design by:  
Holly M Breuer  
(570) 262-5141

# Chicago

Groundplan

Plate 1 of 7

May 2, 2011

Scale :  $\frac{1}{4}$ " = 1'-0"

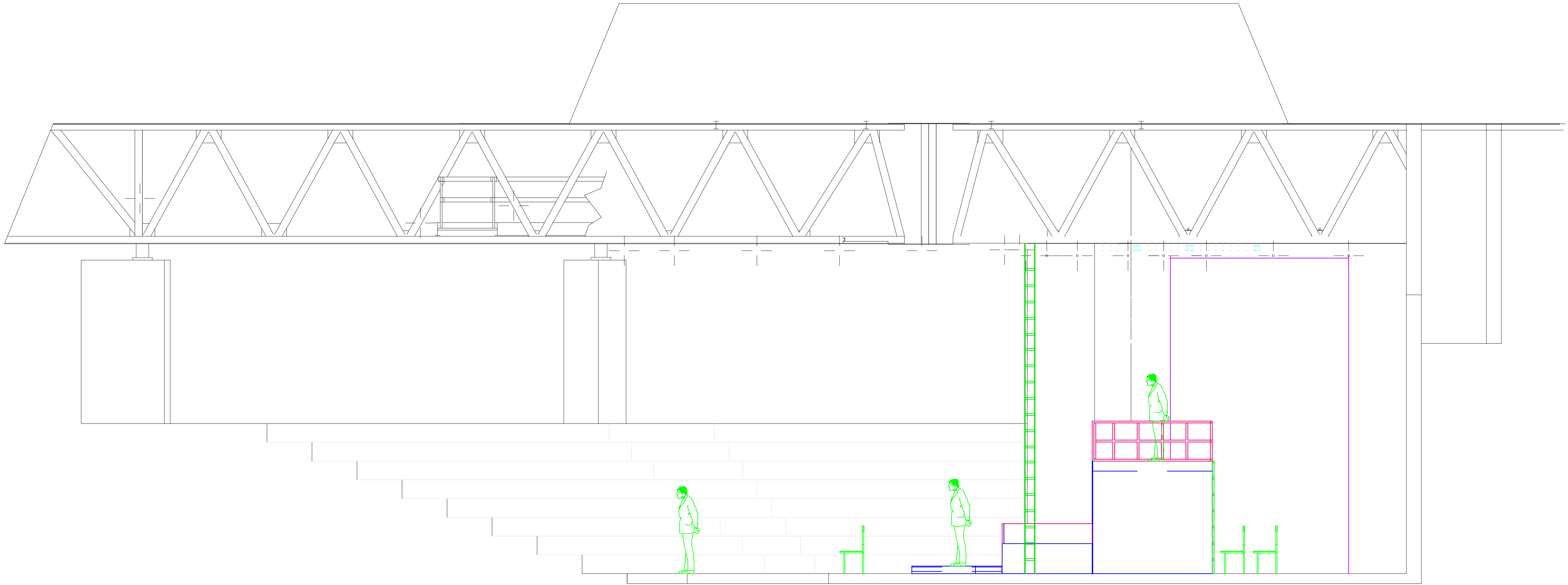

Porthouse Theatre  
Kent State Univ.  
1325 Theatre Dr.  
PO Box 5190  
Kent, OH 44242

Director: Terri Kent  
Set Design by:  
Holly M Breuer  
(570) 262-5141

# Chicago

Section

Plate 2 of 7

May 2, 2011

Scale :  $\frac{1}{4}$  " = 1'-0"

Porthouse Theatre  
Kent State Univ.  
1325 Theatre Dr.  
PO Box 5190  
Kent, OH 44242

Director: Terri Kent  
Set Design by:  
Holly M Breuer  
(570) 262-5141

# Chicago

Platforms  
B & D

Plate 3 of 7

May 2, 2011

Scale :  $\frac{1}{2}$ " = 1'-0"

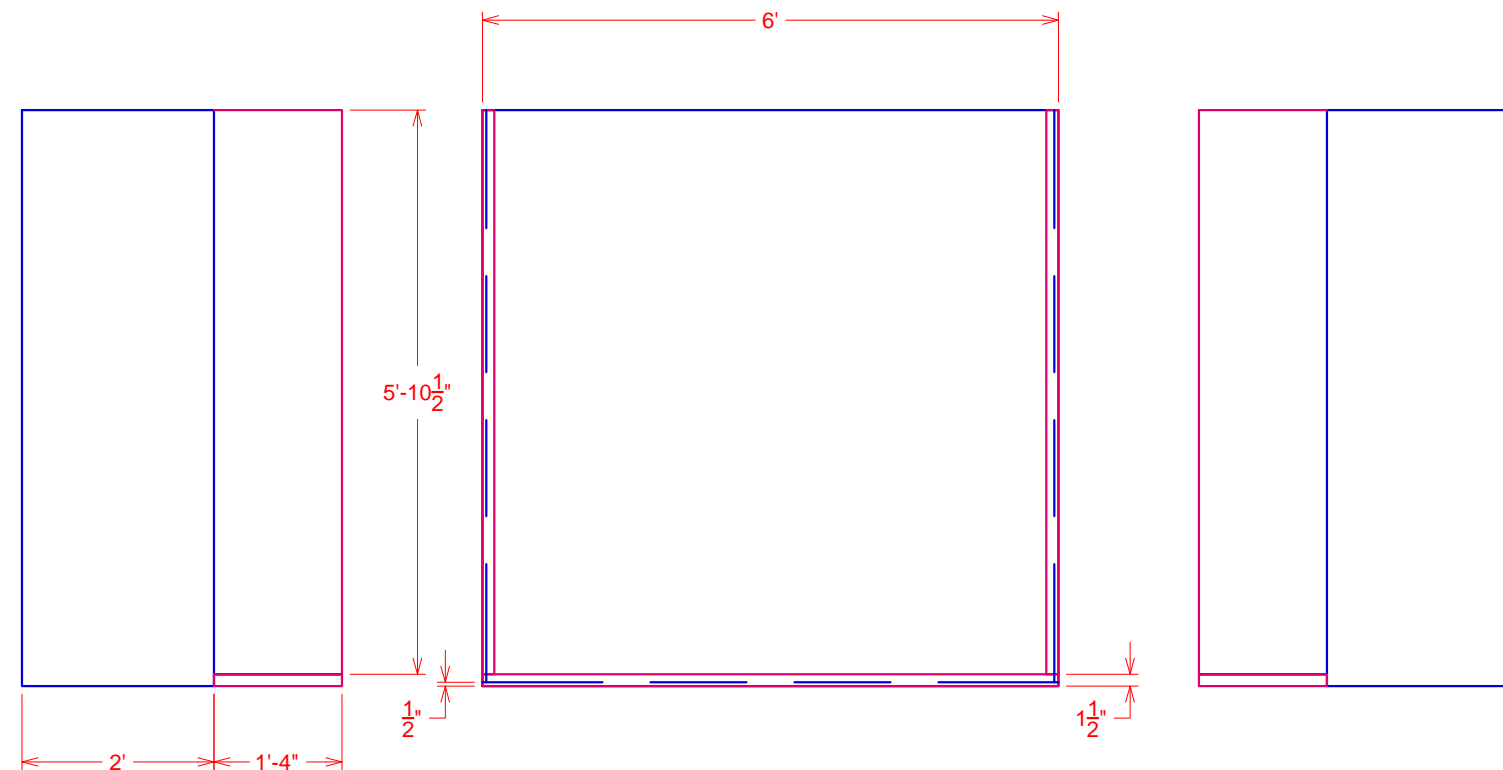

Platform B and D (identical)

## Notes:

- 1.Build (2)
- 2.Facing on bottom half is attached to outside edges of the platform, NOT under lid.
- 3.Facing is spec'd at  $\frac{1}{2}$ " material, but can be changed.
4. Facing should be smooth, so possibly masonite layered over luan.
- 5.Top masking walls attached to top of platform.
- 6.Interior framing and legging of platform at Tech Dir's discretion.
- 7.Side facing (1'-4" high) is to be structural and act as safety rails.
- 8.ALL joints, edges, and hardware are to be covered with Bondo or joint compound PRIOR to being painted.

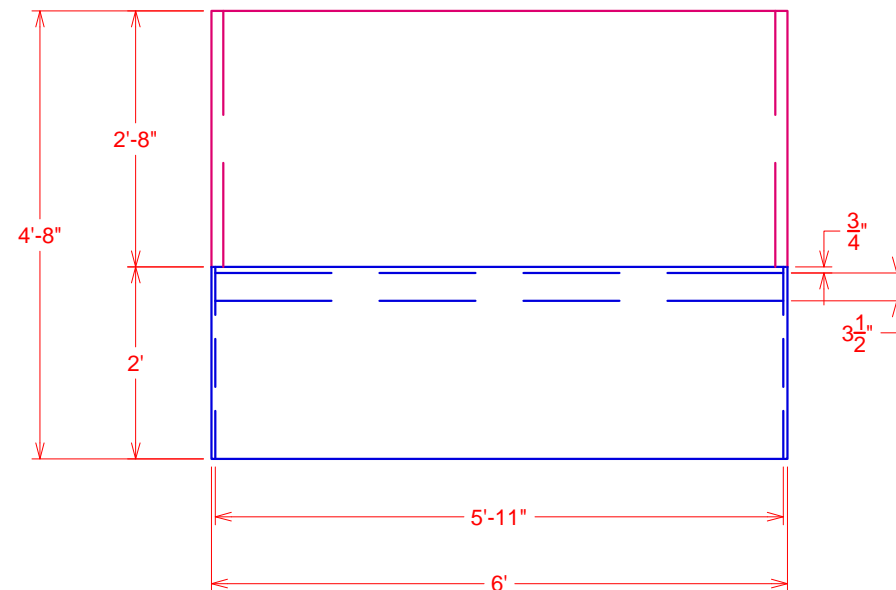

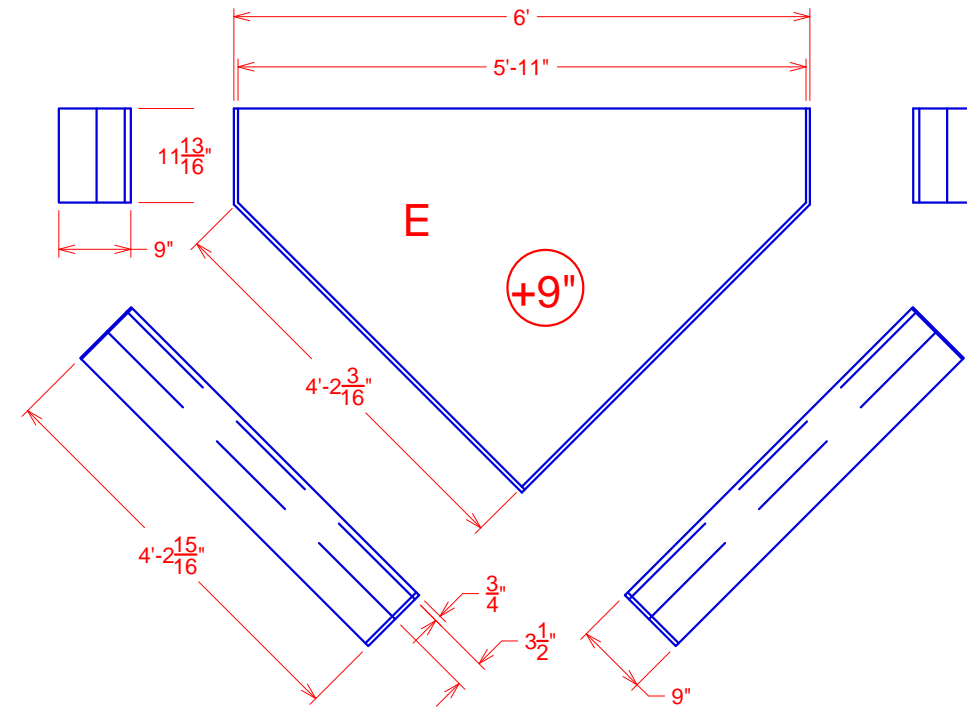
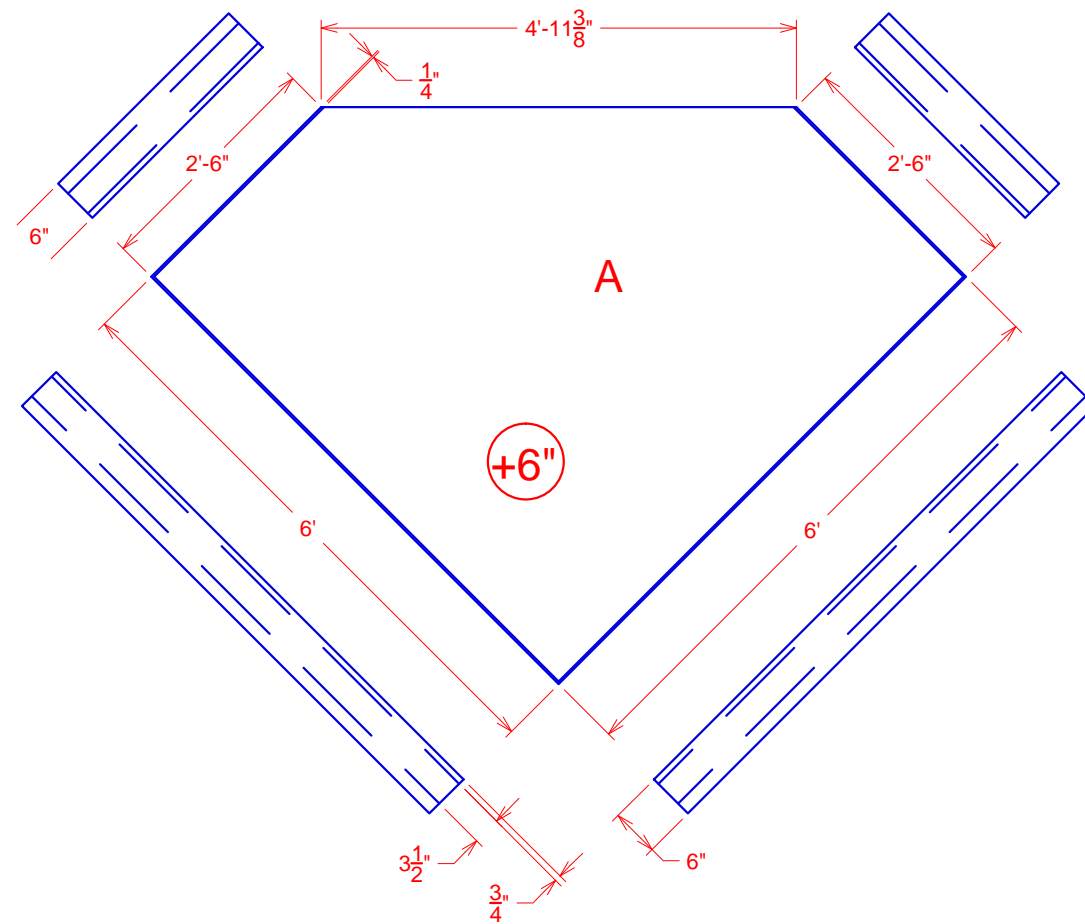

Platform A and E

Notes:

- 1.Facing applied to front edges of platforms.
- 2.Facing is spec'd at  $\frac{1}{4}$ " material, but can be changed.
- 3.Facing should be smooth, so possibly masonite layered over luan.
- 4.Interior framing and legging of platforms at Tech Dir's discretion.
- 5.ALL joints, edges, and hardware are to be covered with Bondo or joint compound PRIOR to being painted.

Porthouse Theatre  
Kent State Univ.  
1325 Theatre Dr.  
PO Box 5190  
Kent, OH 44242

Director: Terri Kent  
Set Design by:  
Holly M Breuer  
(570) 262-5141

# Chicago

Platforms  
A & E  
Plate 4 of 7

May 2, 2011

Scale :  $\frac{1}{2}$ " = 1'-0"

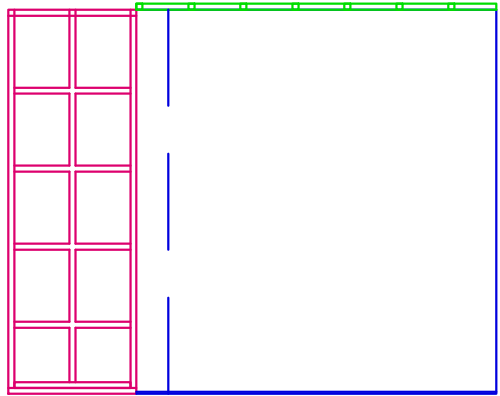
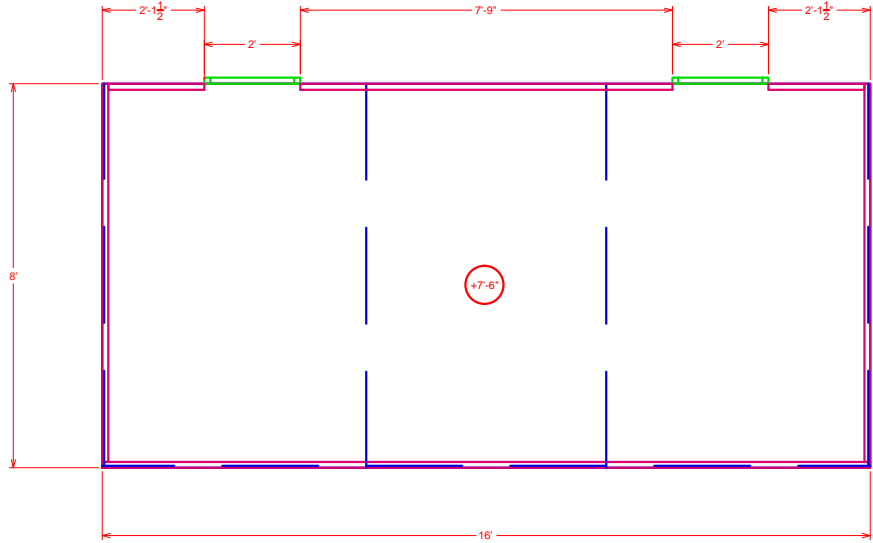
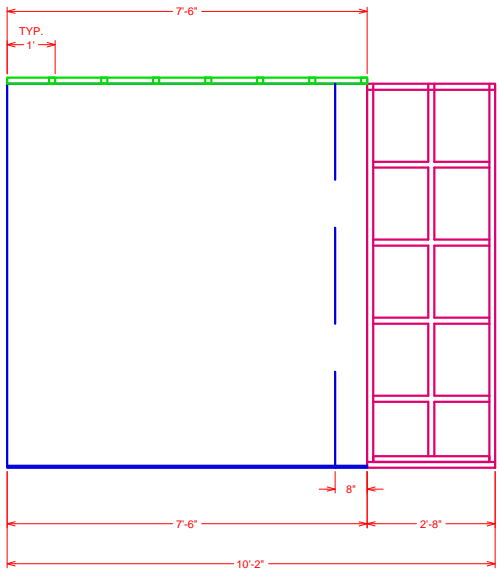
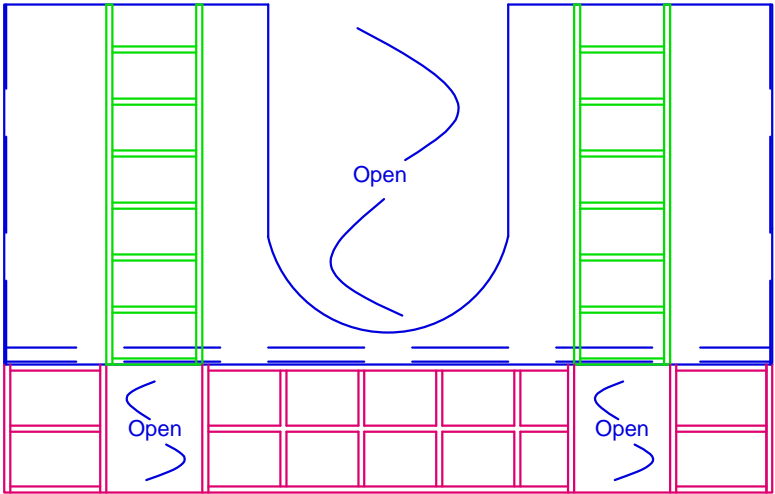

Platform C

- Notes:
1. Facing on bottom half is attached to outside edges of the platform, NOT under lid.
  2. Facing is spec'd at  $\frac{1}{2}$ " material, but can be changed. Facing should be smooth, so possibly masonite layered over luan.
  3. Top masking wall attached to top of platform, and is structural.
  4. Interior framing and legging of unit at Tech Dir's discretion.
  5. Side and rear pipe safety rails may be appropriate stock units, at Tech Dir's discretion.
  6. Interior of Archway is faced with luan or masonite.
  7. ALL joints, edges, and hardware are to be covered with Bondo or joint compound PRIOR to being painted.

Porthouse Theatre  
Kent State Univ.  
1325 Theatre Dr.  
PO Box 5190  
Kent, OH 44242

Director: Terri Kent  
Set Design by:  
Holly M Breuer  
(570) 262-5141

Chicago

Platform  
C  
Plate 5 of 7

May 2, 2011

Scale :  $\frac{1}{4}$ " = 1'-0"

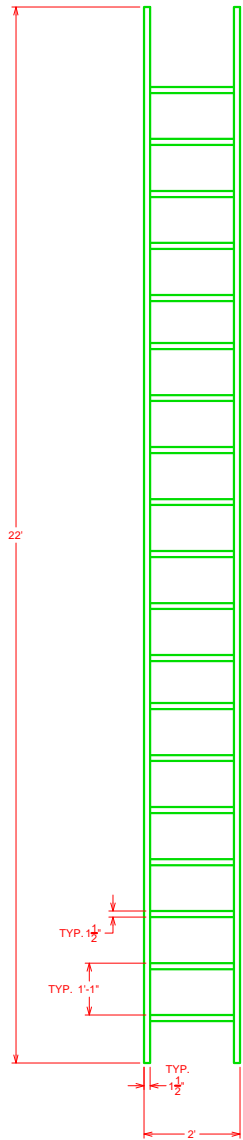

Proscaenium Ladders

- Notes:
- 1.Build (2)
  - 2.To be built of 1 1/2 " box tube.
  - 3.Must swing from back to front of proscaenium arch (see groundplan).
  - 4.Discuss rigging method with Set and Lighting Designers.
  - 5.Must reach from stage deck to grid above.
  - 6.Offstage vertical may need to be pipe not box tube, per Tech Dir's rigging technique.

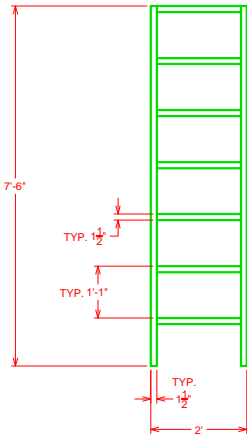

Band Escape Ladder

- Notes:
- 1.Build (2)
  - 2.To be built of 1 1/2 " box tube.
  - 3.Bolt to upstage side of Platform Unit C.

Porthouse Theatre  
Kent State Univ.  
1325 Theatre Dr.  
PO Box 5190  
Kent, OH 44242

Director: Terri Kent  
Set Design by:  
Holly M Breuer  
(570) 262-5141

# Chicago

Ladders

Plate 6 of 7

May 2, 2011

Scale : 1/4" = 1'-0"

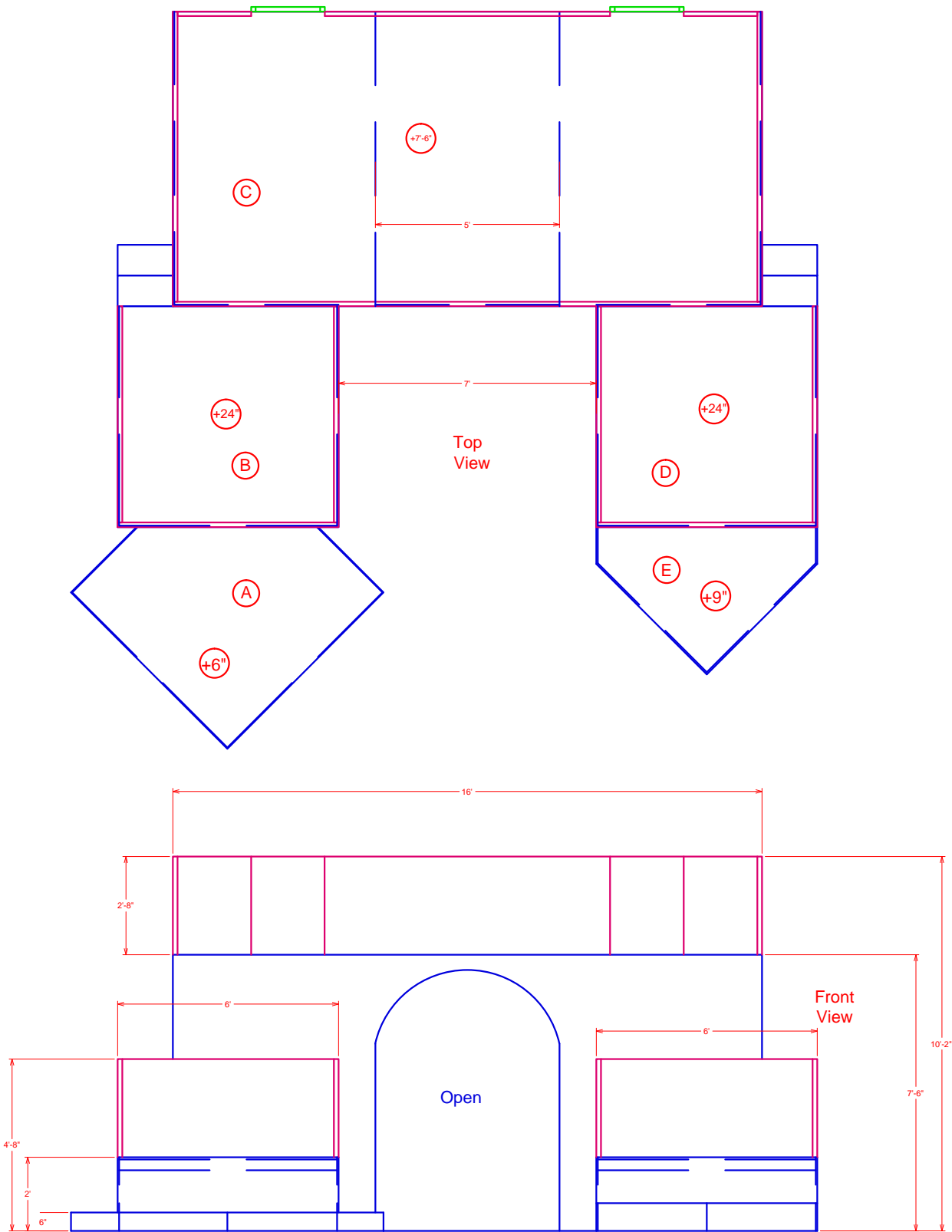

Porthouse Theatre  
Kent State Univ.  
1325 Theatre Dr.  
PO Box 5190  
Kent, OH 44242

Director: Terri Kent  
Set Design by:  
Holly M Breuer  
(570) 262-5141

# Chicago

Front Elevation

Plate 7 of 7

May 2, 2011

Scale :  $\frac{1}{4}$ " = 1'-0"



Porthouse Theatre  
Kent State Univ.  
1325 Theatre Dr.  
PO Box 5190  
Kent, OH 44242

Director: Terri Kent  
Set Design by:  
Holly M Breuer  
(570) 262-5141

# Chicago

## Groundplan

Plate 1 of 7

May 2, 2011

Scale :  $\frac{1}{8}$  " = 1'-0"

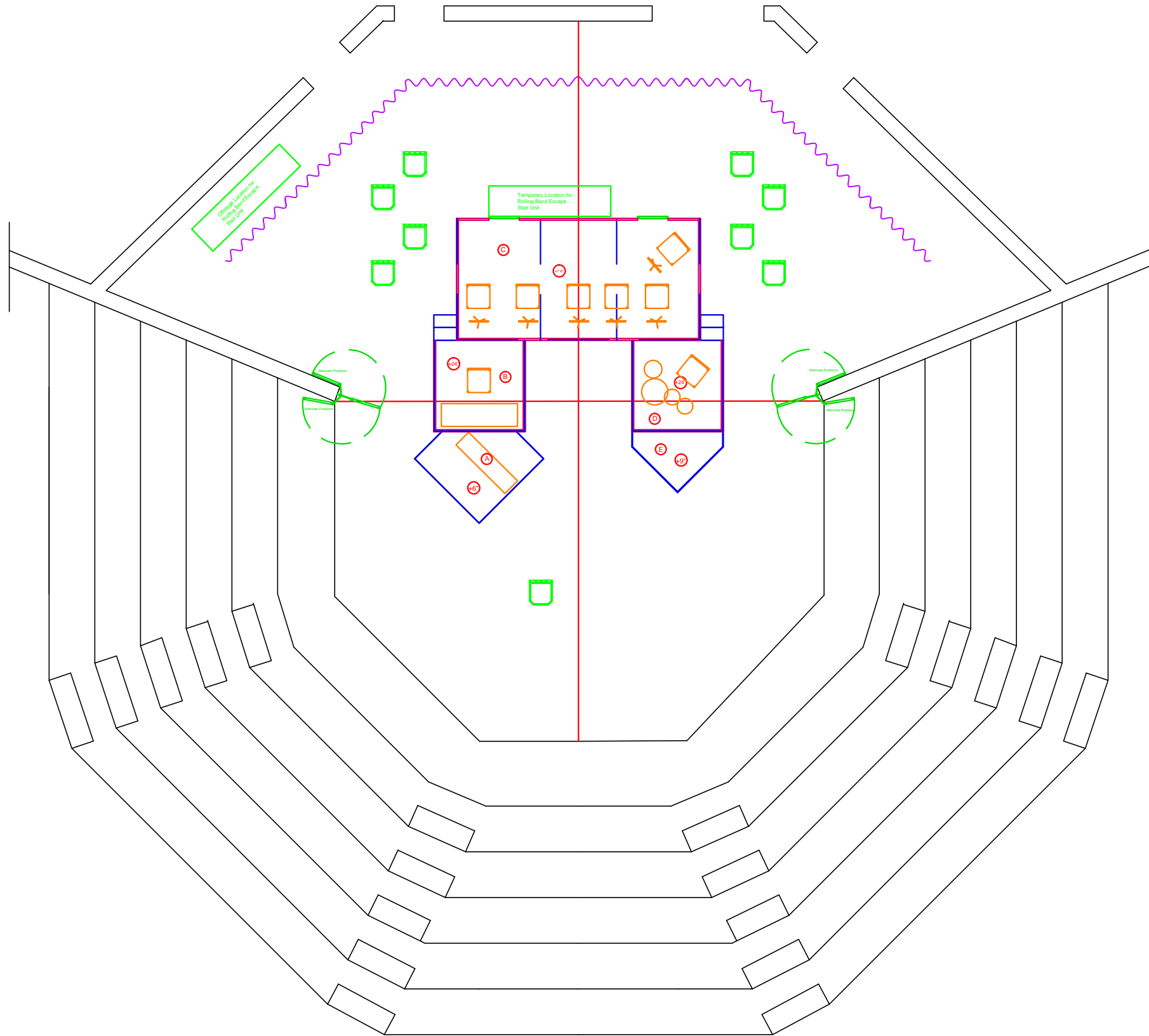

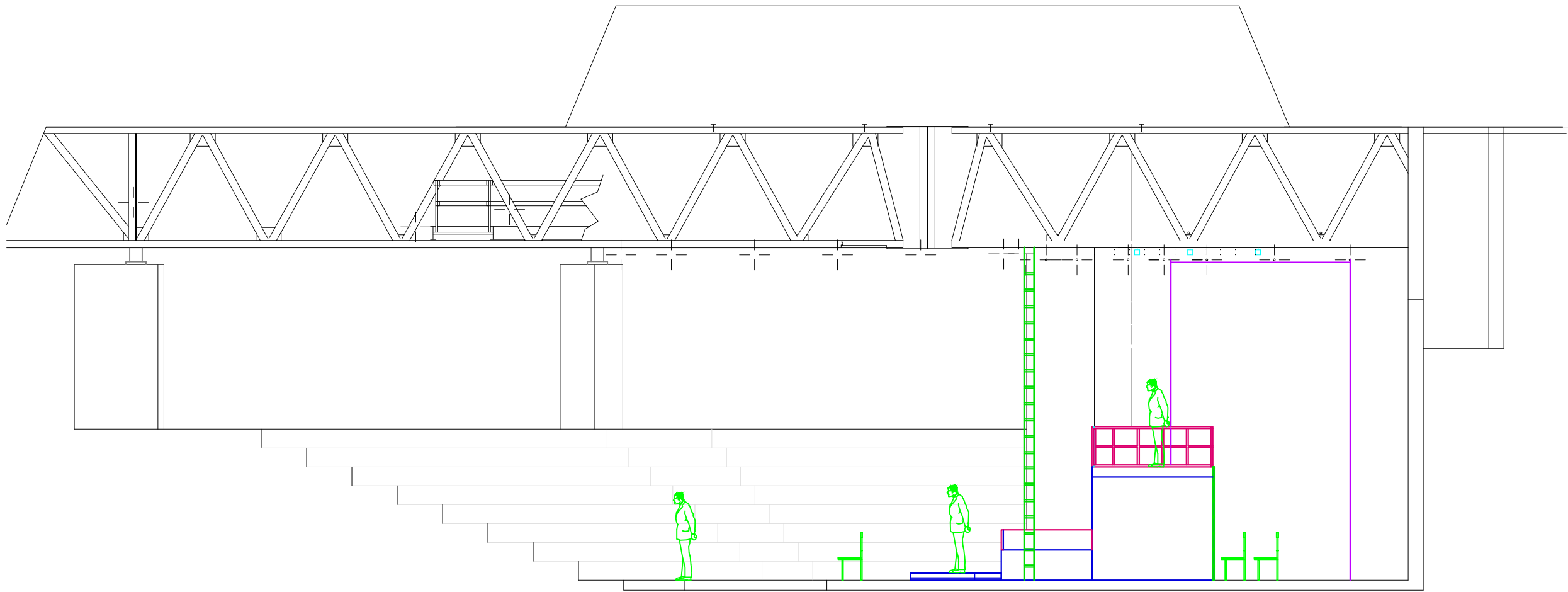

Porthouse Theatre  
Kent State Univ.  
1325 Theatre Dr.  
PO Box 5190  
Kent, OH 44242

Director: Terri Kent  
Set Design by:  
Holly M Breuer  
(570) 262-5141

# Chicago

Section

Plate 2 of 7

May 2, 2011

Scale :  $\frac{1}{8}$ " = 1'-0"